

Storage Fridges- I-Jola P

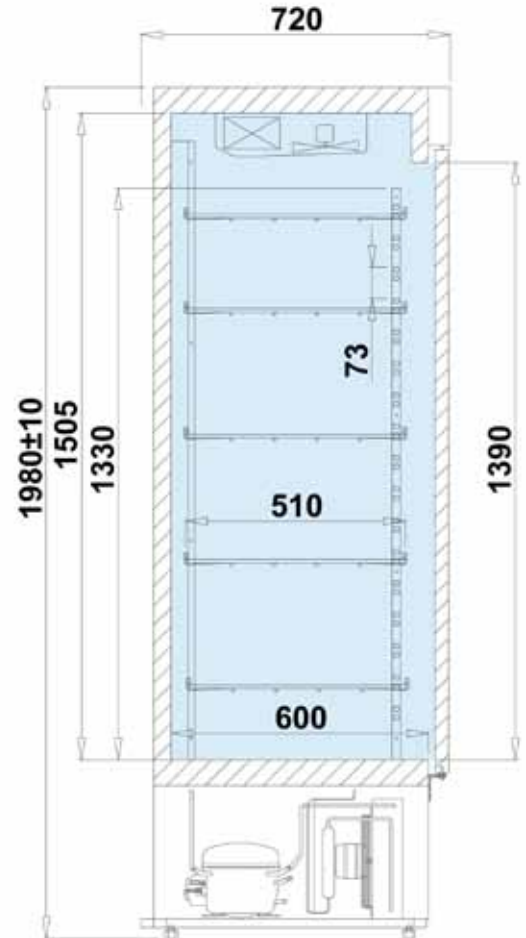
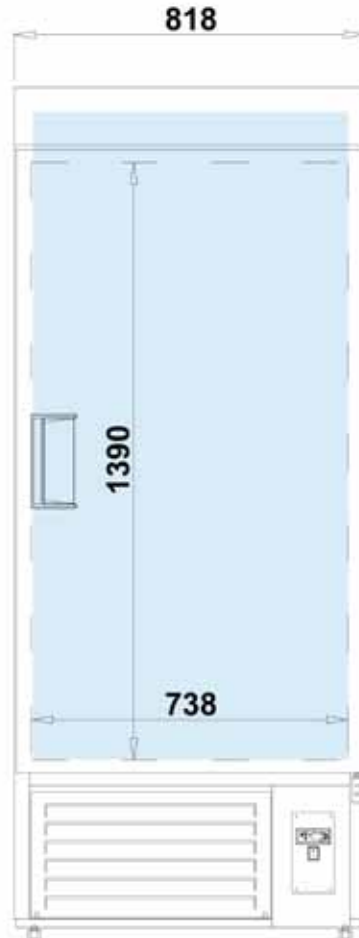

I-Jola P*

Technical parameters:

Model	Dimension (ext.) H x W x D [mm]	Capacity [dm ³]	Shelves with low base	Power Consumption [kWh/24h]	Weight [kg]
I-Jola P	1980 x 818 x 720	700	6	4,70	120

* - Picture above presents unit with either some or all available extras. Please note that the look of basic version of cabinet, or one of your choice, may vary from presented.

Storage Fridges- I-Jola P



I-Jola P*

Description:

- temperature range +1 / +10°C
- preferred ambient temperature +16 / +25°C
- power supply 230V / 50Hz
- internal condensing unit
- ecological polyurethane insulation
- body made of powder coated steel in white colour
- interior made of powder coated steel in white colour
- electronic control with digital temperature display
- self-closing door - choice of door opening direction
- 5 shelves
- forced air circulation with fan switch when doors are opened
- automatic defrost
- water condensate tray
- 1 year full warranty service and after warranty service provided

Available options:

- body made of powder coated steel - optional colours
- body made of stainless steel
- interior made of stainless steel
- horizontally divided doors
- strengthened shelves
- additional shelf
- interior LED illumination
- automatic condensate evaporation

Optional colours:

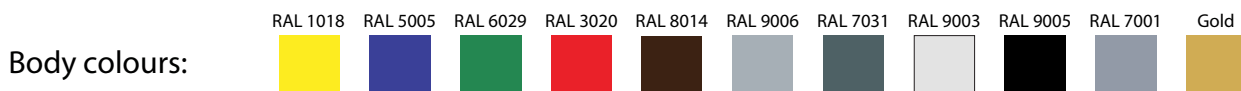

* - Picture above presents unit with either some or all available extras. Please note that the look of basic version of cabinet, or one of your choice, may vary from presented.